

Fysiska institutionen / Department of Physics

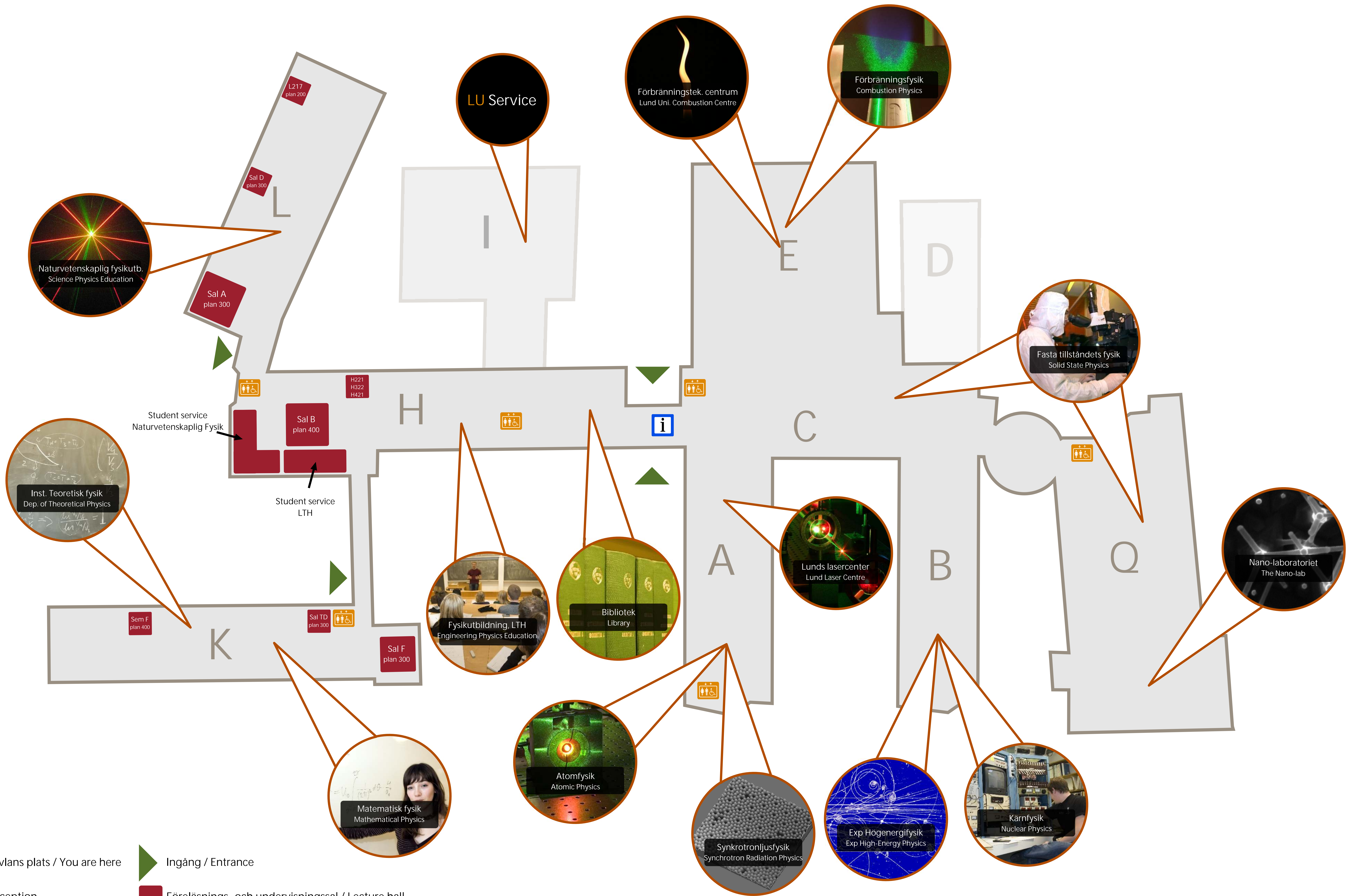

● Tavlan plats / You are here

➤ Ingång / Entrance

ℹ Reception

■ Föreläsnings- och undervisningssal / Lecture hall

♿ Hiss / Elevator

Prefektkansli återfinns i hus H på plan 400 / Head of Department is located in building H on level 400

Nationellt resurscentrum för fysik återfinns i hus H på plan 400 / The National Centre for Education in Physics is located in building H on level 400

Kryolab återfinns i hus E / The Cryogenic Laboratory is located in building E